



TIM CAMPBELL 800-400-7500

Item # _____

Job _____

WIRE SHELVING ACCESSORIES

Shelf Dividers for Super Erecta and Super Adjustable Shelves

Keep shelf contents orderly with these 8" (203mm) high, pressure-fit dividers. Unique design allows them to attach to the top or underside of shelves.

| Model No. Chrome | Model No. Black | Model No. White | Model No. Smoked Glass | Model No. Metroseal 3 with Microban® | Model No. Stainless | Model No. Designer Colors* | Shelf Width (in.) (mm) | Approx. Pkd. Wt. (lbs.) (kg) |
|---------------------|--------------------|--------------------|---------------------------|--|------------------------|-------------------------------|---------------------------|------------------------------------|
| DD14C | DD14BL | DD14W | DD14-DSG | DD14K3 | DD14S | DD14-D | 14 355 | 1.8 0.8 |
| DD18C | DD18BL | DD18W | DD18-DSG | DD18K3 | DD18S | DD18-D | 18 457 | 2.25 1.0 |
| DD21C | DD21BL | DD21W | DD21-DSG | DD21K3 | DD21S | DD21-D | 21 530 | 2.5 1.1 |
| DD24C | DD24BL | DD24W | DD24-DSG | DD24K3 | DD24S | DD24-D | 24 610 | 2.75 1.3 |
| DD30C | DD30BL | DD30W | DD30-DSG | | DD30S | | 30 760 | 3.25 1.5 |
| DD36C | DD36BL | DD36W | DD36-DSG | | DD36S | | 36 914 | 3.75 1.7 |

Dividers cannot be stacked.

For OTR applications, additional clamping may be required to keep dividers in place. Consult Metro engineering.

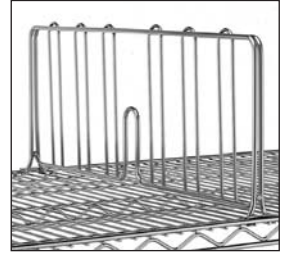

Shelf Divider for Super Erecta Shelves

Shelf Ledges — Side and Back

For stationary or mobile installations, ledges prevent items from protruding or falling from shelves.

1" (25mm) High Ledges

| Model No. Chrome | Model No. Black | Model No. White | Model No. Smoked Glass | Model No. Stainless | Model No. Designer Colors* | Length (in.) (mm) | Approx. Pkd. Wt. (lbs.) (kg) |
|---------------------|--------------------|--------------------|---------------------------|------------------------|-------------------------------|----------------------|------------------------------------|
| L14N-1C | L14N-1BL | L14N-1W | L14N-1-DSG | L14N-1S | L14N-1-D | 14 355 | 0.58 0.25 |
| L18N-1C | L18N-1BL | L18N-1W | L18N-1-DSG | L18N-1S | L18N-1-D | 18 457 | 0.75 0.33 |
| L21N-1C | L21N-1BL | L21N-1W | L21N-1-DSG | L21N-1S | L21N-1-D | 21 530 | 0.75 0.33 |
| L24N-1C | L24N-1BL | L24N-1W | L24N-1-DSG | L24N-1S | L24N-1-D | 24 610 | 1.0 0.45 |
| L30N-1C | L30N-1BL | L30N-1W | L30N-1-DSG | L30N-1S | L30N-1-D | 30 760 | 2.0 0.9 |
| L36N-1C | L36N-1BL | L36N-1W | L36N-1-DSG | L36N-1S | L36N-1-D | 36 914 | 2.5 1.13 |
| L42N-1C | L42N-1BL | L42N-1W | L42N-1-DSG | L42N-1S | L42N-1-D | 42 1066 | 2.75 1.25 |
| L48N-1C | L48N-1BL | L48N-1W | L48N-1-DSG | L48N-1S | L48N-1-D | 48 1219 | 3.5 1.58 |
| L54N-1C | L54N-1BL | L54N-1W | L54N-1-DSG | L54N-1S | L54N-1-D | 54 1370 | 4.4 1.65 |
| L60N-1C | L60N-1BL | L60N-1W | L60N-1-DSG | L60N-1S | L60N-1-D | 60 1524 | 3.75 1.68 |
| L72N-1C | L72N-1BL | L72N-1W | L72N-1-DSG | L72N-1S | L72N-1-D | 72 1828 | 4.0 1.81 |

Note: Actual length is approximately 1" (25mm) shorter than nominal shelf length/width.

1" (25mm) ledges are not stackable.

Ledges may also be used on the interior of a shelf (lengthwise) by attaching directly above a snake truss. Interior snake trusses are found on shelf widths of 21" (530mm) and larger.

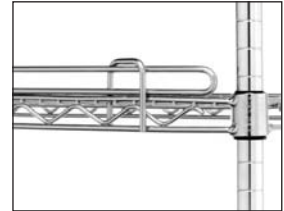

1" (25mm) Ledge

4" (100mm) High Stackable Ledges

Ledges may be stacked to form an 8" (203mm) or higher barrier.

| Model No. Chrome | Model No. Black | Model No. White | Model No. Smoked Glass | Model No. Metroseal 3 with Microban® | Model No. Stainless | Model No. Designer Colors* | Shelf Width (in.) (mm) | Approx. Pkd. Wt. (lbs.) (kg) |
|---------------------|--------------------|--------------------|---------------------------|--|------------------------|----------------------------------|------------------------------|------------------------------------|
| L14N-4C | L14N-4BL | L14N-4W | L14N-4-DSG | L14N-4K3 | L14N-4S | L14N-4-D | 14 355 | 0.8 0.3 |
| L18N-4C | L18N-4BL | L18N-4W | L18N-4-DSG | L18N-4K3 | L18N-4S | L18N-4-D | 18 457 | 1.5 0.6 |
| L21N-4C | L21N-4BL | L21N-4W | L21N-4-DSG | L21N-4K3 | L21N-4S | L21N-4-D | 21 530 | 1.7 0.7 |
| L24N-4C | L24N-4BL | L24N-4W | L24N-4-DSG | L24N-4K3 | L24N-4S | L24N-4-D | 24 610 | 2.0 0.9 |
| L30N-4C | L30N-4BL | L30N-4W | L30N-4-DSG | L30N-4K3 | L30N-4S | L30N-4-D | 30 760 | 2.2 1.0 |
| L36N-4C | L36N-4BL | L36N-4W | L36N-4-DSG | L36N-4K3 | L36N-4S | L36N-4-D | 36 914 | 2.7 1.2 |
| L42N-4C | L42N-4BL | L42N-4W | L42N-4-DSG | L42N-4K3 | L42N-4S | L42N-4-D | 42 1066 | 3.2 1.4 |
| L48N-4C | L48N-4BL | L48N-4W | L48N-4-DSG | L48N-4K3 | L48N-4S | L48N-4-D | 48 1219 | 3.7 1.6 |
| L54N-4C | L54N-4BL | L54N-4W | L54N-4-DSG | L54N-4K3 | L54N-4S | L54N-4-D | 54 1370 | 3.8 1.7 |
| L60N-4C | L60N-4BL | L60N-4W | L60N-4-DSG | L60N-4K3 | L60N-4S | L60N-4-D | 60 1524 | 4.0 1.8 |
| L72N-4C | L72N-4BL | L72N-4W | L72N-4-DSG | L72N-4K3 | L72N-4S | L72N-4-D | 72 1828 | 5.0 2.2 |

Note: Actual length is approximately 1" (25mm) shorter than nominal shelf length/width.

Ledges may also be used on the interior of a shelf (lengthwise) by attaching directly above a snake truss. Interior snake trusses are found on shelf widths of 21" (530mm) and larger.

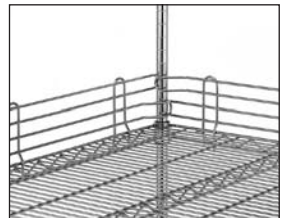

4" (102mm) Ledge

Designer Shelf Colors

*To order a Designer Color, add the appropriate color suffix to the desired catalog numbers above (example: 18"x36" [457x914mm] Hunter Green Shelf = 1836N-DHG).

BM — Black Matte **SH** — Silver Hammertone **HG** — Hunter Green
F — Flame **CH** — Copper Hammertone



Snap-On Dividers for Drop Mat Shelves

Organize your shelves with these 8" (203mm) high, easy to snap-in-place dividers.

| Model No. Chrome | Model No. Black | Model No. White | Model No. Smoked Glass | Model No. Designer Colors* | Fits Shelf Width | | Approx. Pkd. Wt. | |
|---------------------|--------------------|--------------------|---------------------------|-------------------------------|---------------------|------|---------------------|------|
| | | | | | (in.) | (mm) | (lbs.) | (kg) |
| HD18C | HD18B | HD18W | HD18-DSG | HD18-D | 18 | 457 | 2.5 | 1.1 |
| HD24C | HD24B | D24W | HD24-DSG | HD24-D | 24 | 614 | 3.5 | 1.6 |

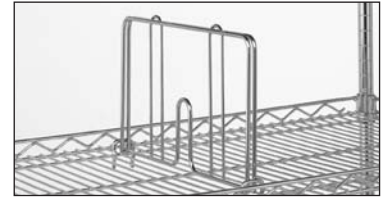

Snap-On Divider

Super Erecta Slide System (for tote boxes)

Using Super Erecta or Super Adjustable Super Erecta wire units, tote boxes, and these innovative slides, you have the flexibility to create a custom configuration that can be positioned quickly on new or existing units without the use of tools.

| Model No. | Outside Slide Dimensions Height/Width/Length | | For Shelf Width (in.) (mm) | Adaptable Boxes | Approx. Pkd. Wt. | |
|-----------|--|-------------|-------------------------------|---|-------------------------------|------|
| | (in.) | (mm) | | | (lbs.) | (kg) |
| SS2NC | 10 ¹ / ₄ x20 ³ / ₈ x21 ⁵ / ₈ | 256x510x537 | 24 610 | TB/MTB93030W, TB/MTB93060W, TB/MTB93080W | 4 ³ / ₄ | 2.1 |
| SS3NC | 10 ¹ / ₄ x14x17 ¹ / ₈ | 256x355x430 | 21 530 | TB/MTB92035W, TB/MTB92060W, TB/MTB92080W | 3 ¹ / ₂ | 1.5 |
| SS4NC | 10 ¹ / ₄ x25 ¹ / ₈ x17 ¹ / ₈ | 256x630x430 | 21 530 | TB/MTB93030W,* TB/MTB93060W,* TB/MTB93080W* | 4 | 1.8 |

*Fits SS4NC with box turned sideways.

Note:
SS2NC may also be used on 30" (760mm) and 36" (910mm) width shelves.
Load ratings: 25 lbs. (11.3kg) max per slide level, not to exceed 50 lbs. (22.6 kg) per slide system.
These slides do NOT work with 12"x20" (305x508mm) steam table pans or 18"x26" (457x660mm) bun pans.

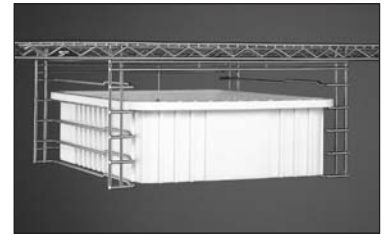

Super Erecta Slide System in place on shelf (Tote box sold separately)

One-Piece Slides

One-piece solid slide attaches easily to shelf with support brackets.

| Model No. | For Shelf Width (in.) (mm) | Approx. Pkd. Wt. (lbs.) (kg) |
|-----------|-------------------------------|------------------------------------|
| BSD2224NB | 24 610 | 5 ¹ / ₂ 2.47 |

Not adaptable to 24" (610mm) long shelf.
Can use (2) on a 24"x48" (610x1219mm) shelf.
Can use (3) on a 24"x60" (610x1524mm) shelf.

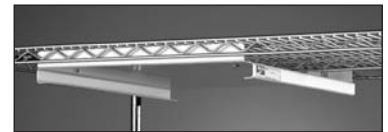

One-Piece Slide

Adjustable Undershelf Slides

These slides can be spaced to fit any width container or tote box.

| Model No. (pair) | For Shelf Width (in.) (mm) | Approx. Pkd. Wt. (lbs.) (kg) |
|---------------------|-------------------------------|------------------------------------|
| US18NA | 18 457 | 1 0.4 |
| US21NA | 21 530 | 1 0.4 |
| US24NA | 24 610 | 1 0.4 |

*Not adaptable to 24" (610mm) long shelf.

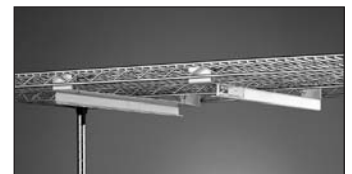

Adjustable Undershelf Slide

Tray Slides

Free up shelves for more efficient use of space. Adaptable slides work with TB93000 and MTB93000 series tote boxes, 12"x20" (305x508mm) steam table pans, or 18"x26" (457x660mm) bun pans. Available in chrome and Metroseal 3 finishes. 22³/₄" H (578mm).

| Model No. Chrome | Model No. Metroseal 3 with Microban® | Width | | Overall Depth | | Slide Profile | | On Center Slide Spacing | | Fits Shelf Width | | Approx. Weight/Pair | |
|---------------------|--|--------------------------------|------|-------------------------------|------|-------------------------------|------|-------------------------------|------|---------------------|------|-------------------------------|------|
| | | (in.) | (mm) | (in.) | (mm) | (in.) | (mm) | (in.) | (mm) | (in.) | (mm) | (lbs.) | (kg) |
| 15SNC | 15SNK3 | 14 ⁵ / ₈ | 371 | 2 ¹ / ₄ | 56 | 1 ¹ / ₂ | 37 | 1 ¹ / ₂ | 37 | 18 | 457 | 9 ¹ / ₂ | 4.3 |
| 20SNC | 20SNK3 | 20 | 508 | 2 ¹ / ₄ | 56 | 1 ¹ / ₂ | 37 | 1 ¹ / ₂ | 37 | 24 | 610 | 11 | 5.0 |

Load rating: 25 lbs. (11.3kg) max per slide level, not to exceed 50 lbs. (22.6kg) per slide system.
20SNC / K3 will fit 30" (760mm) and 36" (910mm) shelves.

| Shelf Lengths | Tray Slides per Level |
|----------------------------------|-----------------------|
| 24" (610mm) through 42" (1066mm) | 1 |
| 48" (1219mm) | 1 or 2 |
| 60" (1524mm) | 2 |
| 72" (1829mm) | 2 or 3 |



Tray Slides

*MICROBAN® and the MICROBAN® symbol are registered trademarks of the Microban Products Company, Huntersville, NC.



WIRE SHELVING ACCESSORIES

Enclosure Panels

An efficient way to enclose space for stationary or mobile applications.

- Can be used with Super Erecta® and Super Adjustable wire shelving, and Super Erecta solid shelving.
- Appropriate mounting hardware supplied with each panel.



Enclosure Panel

Enclosure Panels for Super Erecta Wire and Solid, Super Adjustable and MetroMax Q Shelving Units

| Model No. Chrome | Model No. Stainless | Width/Height | | For Nominal Post Height | | Grid Opening | | Weight | |
|---------------------|------------------------|---|------------|-------------------------|------|---|---------|--------|------|
| | | (in.) | (mm) | (in.) | (mm) | (in.) | (mm) | (lbs.) | (kg) |
| EP35C | EP35S | 12 ³ / ₈ x 50 ³ / ₄ | 313 x 1289 | 54 | 1370 | 2 ⁷ / ₈ x 3 ⁵ / ₈ | 73 x 92 | 3 | 1.4 |
| EP36C | EP36S | 12 ³ / ₈ x 59 ³ / ₄ | 313 x 1518 | 63 | 1600 | 2 ⁷ / ₈ x 3 ⁵ / ₈ | 73 x 92 | 4 | 1.8 |
| EP37C | — | 12 ³ / ₈ x 70 ¹ / ₂ | 313 x 1791 | 74 | 1880 | 2 ⁷ / ₈ x 3 ⁵ / ₈ | 73 x 92 | 6 | 2.7 |
| EP55C | EP55S | 18 ³ / ₈ x 50 ³ / ₄ | 464 x 1289 | 54 | 1370 | 3 ³ / ₈ x 3 ⁵ / ₈ | 86 x 92 | 5 | 2.3 |
| EP56C | EP56S | 18 ³ / ₈ x 59 ³ / ₄ | 464 x 1518 | 63 | 1600 | 3 ³ / ₈ x 3 ⁵ / ₈ | 86 x 92 | 6 | 2.7 |
| EP57C | — | 18 ³ / ₈ x 70 ¹ / ₂ | 464 x 1791 | 74 | 1880 | 3 ³ / ₈ x 3 ⁵ / ₈ | 86 x 92 | 7 | 3.2 |

All panels are 7/8" (22mm) thick.

Panels Required for Super Erecta Wire and Solid and Super Adjustable Shelving Units

Ends — Panels required for each end, as follows:

| Nominal Post Height (in.) | Nominal Post Height (mm) | 18" (457mm) | | 21" (530mm) | | 24" (610mm) | | 30" (760mm) | | 36" (914mm) | |
|------------------------------|-----------------------------|---------------------|---------------------|---------------------|---------------------|---------------------|---------------------|---------------------|---------------------|-------------|--|
| | | Nominal Shelf Width | Nominal Shelf Width | Nominal Shelf Width | Nominal Shelf Width | Nominal Shelf Width | Nominal Shelf Width | Nominal Shelf Width | Nominal Shelf Width | | |
| 54 | 1370 | EP35 | EP35 | EP55 | EP55 | (2) EP35 | (1) EP35 | (1) EP35 | (1) EP55 | | |
| 63 | 1600 | EP36 | EP36 | EP56 | EP56 | (2) EP36 | (1) EP36 | (1) EP36 | (1) EP56 | | |
| 74 | 1880 | EP37 | EP37 | EP57 | EP57 | (2) EP37 | (1) EP37 | (1) EP37 | (1) EP57 | | |

Backs — Require multiple panels as follows:

WIRE SHELVES

| Nominal Post Height (in.) | Nominal Post Height (mm) | 30" (760mm) | | 36" (914mm) | | 42" (1060mm) | | 48" (1219mm) | | 54" (1370mm) | | 60" (1524mm) | | 72" (1825mm) | |
|------------------------------|-----------------------------|----------------------|----------------------|----------------------|----------------------|----------------------|----------------------|----------------------|----------------------|----------------------|----------------------|----------------------|----------------------|----------------------|--|
| | | Nominal Shelf Length | Nominal Shelf Length | Nominal Shelf Length | Nominal Shelf Length | Nominal Shelf Length | Nominal Shelf Length | Nominal Shelf Length | Nominal Shelf Length | Nominal Shelf Length | Nominal Shelf Length | Nominal Shelf Length | Nominal Shelf Length | Nominal Shelf Length | |
| 54 | 1370 | (2) EP35 | (1) EP35, (1) EP55 | (2) EP55 | (2) EP35, (1) EP55 | (1) EP35, (2) EP55 | (3) EP55 | (1) EP35, (3) EP55 | | | | | | | |
| 63 | 1600 | (2) EP36 | (1) EP36, (1) EP56 | (2) EP56 | (2) EP36, (1) EP56 | (1) EP36, (2) EP56 | (3) EP56 | (1) EP36, (3) EP56 | | | | | | | |
| 74 | 1880 | (2) EP37 | (1) EP37, (1) EP57 | (2) EP57 | (2) EP37, (1) EP57 | (1) EP37, (2) EP57 | (3) EP57 | (1) EP37, (3) EP57 | | | | | | | |

SOLID SHELVES

| Nominal Post Height (in.) | Nominal Post Height (mm) | 30" (760mm) | | 36" (914mm) | | 42" (1060mm) | | 48" (1219mm) | | 54" (1370mm) | | 60" (1524mm) | | 72" (1825mm) | |
|------------------------------|-----------------------------|----------------------|----------------------|----------------------|----------------------|----------------------|----------------------|----------------------|----------------------|----------------------|----------------------|----------------------|----------------------|----------------------|--|
| | | Nominal Shelf Length | Nominal Shelf Length | Nominal Shelf Length | Nominal Shelf Length | Nominal Shelf Length | Nominal Shelf Length | Nominal Shelf Length | Nominal Shelf Length | Nominal Shelf Length | Nominal Shelf Length | Nominal Shelf Length | Nominal Shelf Length | Nominal Shelf Length | |
| 54 | 1370 | (1) EP55 | (2) EP35 | (1) EP35, (1) EP55 | (2) EP55 | — | (1) EP35, (2) EP55 | — | | | | | | | |
| 63 | 1600 | (1) EP56 | (2) EP36 | (1) EP36, (1) EP56 | (2) EP56 | — | (1) EP36, (2) EP56 | — | | | | | | | |
| 74 | 1880 | (1) EP57 | (2) EP37 | (2) EP37, (1) EP57 | (2) EP57 | — | (1) EP37, (2) EP57 | — | | | | | | | |

Note: Units with a solid shelf in the top position require the use of a three-sided snake frame directly below it.

Replacement Mounting Kit for Enclosure Panel

Model No. **9970EPZ**



Mounting Kit for Enclosure Panel

Replacement Clamps

Model No. **9970Z**

Bag of 8 clamp assemblies.

(Available by the bag only)





WIRE SHELVING ACCESSORIES

Rods

Form side and back enclosures for a shelving unit. Can also serve as uniform dividers within unit by passing through shelves from top to bottom. Recommended spacing: every 6" (150mm) to 12" (305mm), depending upon shelf contents.

| Model No. Chrome | Model No. Stainless | Min. Post Height (in.) | Rod Length (in.) (mm) | | Approx. Pkd. Wt. (lbs.) (kg) | |
|---------------------|------------------------|------------------------------|--------------------------|------|------------------------------------|-----|
| R52C | R52S | 54 | 52 | 1320 | 1 | 0.5 |
| R61C | R61S | 63 | 61 | 1549 | 1 | 0.5 |
| R72C | R72S | 74 | 72 | 1830 | 1 ¹ / ₄ | 0.6 |
| R84C | R84S | 86 | 84 | 2135 | 1 ¹ / ₂ | 0.7 |



Rod with Tab in place

Tabs

Rods are shipped with 4 tabs per rod.
Additional Tabs — Bag of 12 Model No. **9084Z**

Three-Sided Double Snake Frames

Provide additional support or access to floor with these sturdy square snake frames. Chrome finish.

| Model No. Chrome | Width/Length (in.) (mm) | | Approx. Pkd. Wt. (lbs.) (kg) | |
|---------------------|----------------------------|----------|------------------------------------|-----|
| SF31N3C | 18x24 | 457x610 | 5 | 2.3 |
| SF32N3C | 18x30 | 457x760 | 6 | 2.7 |
| SF33N3C | 18x36 | 457x914 | 6 ¹ / ₂ | 2.7 |
| SF34N3C | 18x42 | 457x1066 | 7 | 3.2 |
| SF35N3C | 18x48 | 457x1219 | 7 ³ / ₄ | 3.5 |
| SF36N3C | 18x60 | 457x1524 | 8 | 3.6 |
| SF37N3C | 18x72 | 457x1829 | 9 | 4.1 |
| SF41N3C | 21x24 | 530x610 | 5 | 2.3 |
| SF42N3C | 21x30 | 530x760 | 6 | 2.7 |
| SF43N3C | 21x36 | 530x914 | 6 ¹ / ₂ | 2.7 |
| SF44N3C | 21x42 | 530x1066 | 7 | 3.2 |
| SF45N3C | 21x48 | 530x1219 | 8 | 3.6 |
| SF46N3C | 21x60 | 530x1524 | 8 ¹ / ₂ | 3.8 |
| SF47N3C | 21x72 | 530x1829 | 10 | 4.5 |
| SF51N3C | 24x24 | 610x610 | 6 | 2.7 |
| SF52N3C | 24x30 | 610x760 | 7 | 3.2 |
| SF53N3C | 24x36 | 610x914 | 7 ¹ / ₂ | 3.4 |
| SF54N3C | 24x42 | 610x1066 | 8 | 3.6 |
| SF55N3C | 24x48 | 610x1219 | 9 | 4.1 |
| SF56N3C | 24x60 | 610x1524 | 10 | 4.5 |
| SF57N3C | 24x72 | 610x1829 | 11 | 5.0 |



Three-sided Double Snake Frame